

## Operation Manual

### Airbrush Airbrush-Spray Booth Compressor Suction Unit Paint E420

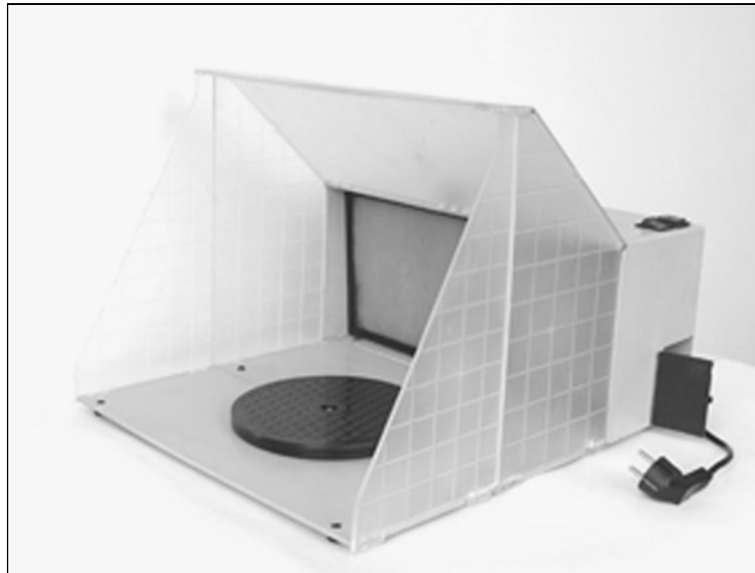

Read and follow the operating instructions and safety information before using for the first time.

**Technical changes reserved!**

Due to further developments illustrations, functioning steps and technical data can differ insignificantly.

**Updating the documentation**

If you have suggestions for improvement or have found any irregularities please contact us.



The information contained in this document is subject to change without prior notice. No part of this document can be copied or duplicated in another form without the prior written consent of Wiltec Wildanger Technik GmbH. The Wiltec Wildanger Technik GmbH assumes no liability for any errors in this user manual or for the connection diagram.

Although Wiltec Wildanger Technik GmbH has made every effort to make sure that this user manual is complete, accurate and updated, errors cannot always be avoided. In the event of problems with this user manual please complete and send this form back to us.

FAX-notification (+++49 2403 55592-15),

from: \_\_\_\_\_

Name: \_\_\_\_\_

Firm: \_\_\_\_\_

Tel/Fax: \_\_\_\_\_

I would like to report the following mistakes:

---

Customer Service Wiltec Wildanger Technik GmbH

e-mail: [service@wiltec.info](mailto:service@wiltec.info)

Tel:++ +49 2403 55592-0

#### **Introduction**

Thank you for purchasing this quality product. **To minimize the risk of injury by means of fire or electric shock we urge that our clients take some basic safety precautions when using this device. Please read the operation instructions carefully and make sure you have understood its content.**

Always use a grounded power connection with the appropriate mains voltage. You can find the corresponding mains voltage on the type plate. If you have any doubts about the connection being grounded, have it checked by a qualified professional. Never use a faulty electric cable.

Do not open the device in a wet or damp environment or when you are wet yourself and protect it from direct sunlight. Install this device in a safe location so that nobody can step on the cable, fall over or damage it. Make sure additionally you provide sufficient cooling through the ambient air and avoid heat accumulation. Disconnect the power plug before cleaning the unit and use only a damp cloth for cleaning. Avoid using cleaning agents and take care that no fluids penetrate into the device.

The interior of the unit contains no parts that can be inspected or serviced by the user. Leave the maintenance, adjustment and repair to qualified technical personnel. In case of unauthorised intervention the 2-year warranty is no longer valid! Keep this operation manual safe.

## Safety precautions



The use of this device is allowed only with fault current protection switch with a triggering nominal current up to 30mA (according to VDE 0100 Article 702 and 738).

The device is not intended for use by persons (including children) with impaired or limited physical, sensory and mental abilities or lack of experience and/or real knowledge, unless they are supervised by a person responsible for their safety or you follow the instructions made by this person how to use the device correctly.

Children should be supervised to make sure that they do not play with the device.



- Run a visual inspection of the device before every use. Do not use the device if the safety appliances are damaged or worn out. Never override safety regulations.
- Use the device exclusively according to the intended purpose stated in the instructions for use.
- You are responsible for the safety of the working environment.
- If the cable or the plug is damaged due to external influences the cable must not be repaired! It has to be replaced with a new one. This work can be carried out only by an electrician.
- The voltage indicated on the type plate of the device of 230 Volt alternating voltage has to correspond to the existent mains voltage.
- Never lift, carry or fixate the device by using the power cable.
- Make sure that the electrical plug connection is placed in a flood-proof area and is protected from moisture.
- Disconnect the mains plug before starting the maintenance work at the compressor.
- The user is responsible for complying with the location specific safety and mounting regulations (you can ask an electrician)
- In case of device failure the repairs can be carried out only by an electrician or by the WilTec-repair service.



- Never expose the device to dust, acid, steam, explosive or flammable gases or atmospheric influences (rain, sun, fog, snow).
- Never allow children to touch the device if switched-on or to insert the plug. It may cause burns or electric shocks.
- When you start working make sure that all screws are tightened.

## Properties:

7. The Airbrush spray booth can be folded together; it is light and needs little space.
8. It operates with low power consumption at a high airflow; it does not need an exhaust hose, saves energy and protects the environment.
9. It has a very fine mesh filter that removes almost all colour and liquid particles without polluting the environment.
10. It has a power cord with the plug inside the unit; this can be pulled out if needed, at the push of a button the cable is automatically loaded or pulled in.
5. With transparent chamber divisions, two chambers can be combined for large work items if needed.

6. The spray booth has an illuminated on/off switch that illuminates when the unit is on. Low noise operation only 52 dB.
7. The unit has a rotary disk that makes the unit easy to handle.

**Technical data:**

Voltage: 230V  
 Power consumption: 25W  
 Air flow: 3m<sup>3</sup>/min  
 Noise: 52 dB.  
 Dimensions (Open): 42X48X34 CM  
 Dimensions (folded together): 42X15X25 CM  
 Net weight 3.8KG  
 Spare part list: (Depending on Model - Light is optional)

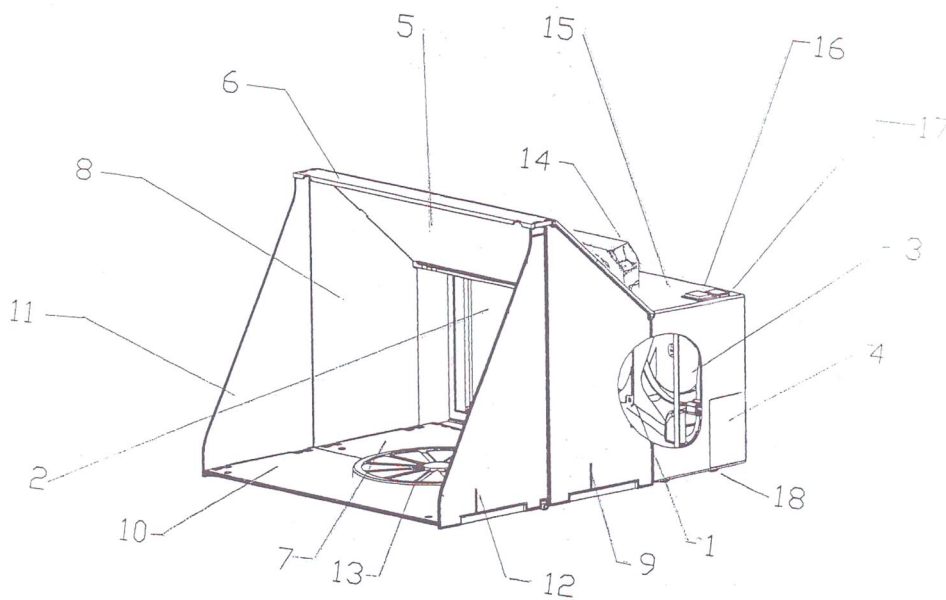

1	Fan	7	Worktop	13	Rotating disk
2	Colour/paint filter	8	Left side plate	14	Carrying handle
3	Cable winding device	9	Right side plate	15	Fan housing
4	Flap door for cable	10	Front worktop	16	Light on/off-switch
5	Upper cover plate	11	Left front worktop	17	Cable-rewinder button
6	Cover plate	12	Right front worktop	18	Rubber bumpers

Hints on usage:



1. The folded spray-booth has a carrying handle and 4 rubber bumpers.

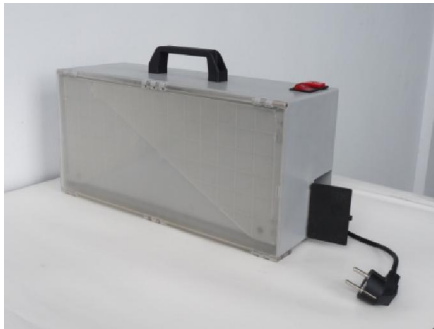

2. Open the small flap door, take out the AC adaptor, which is suitable for 100-240V, the wire can be extended to 2 meters.



3. Fold apart the device: open the front outer surface as upper cover plate of the spray booth.



4. Pull out the front worktop.

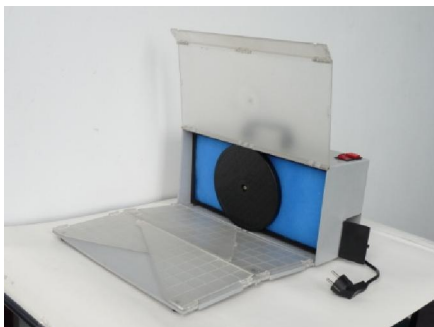

5. Unfold the worktop.

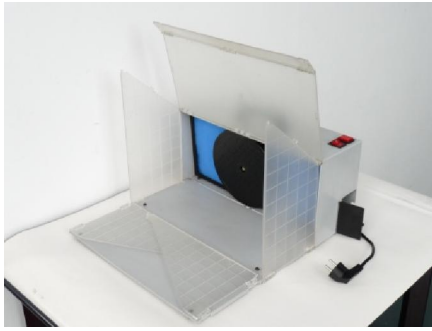

6. Unfold the right and left sideplate to 90°.

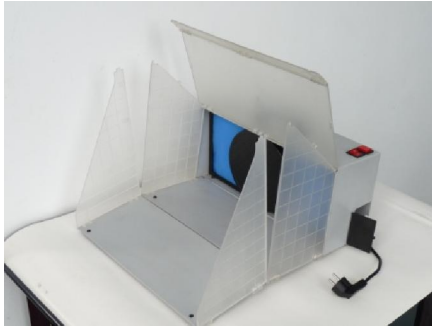

7. Carefully lift the front baseplate, open the right and left sideplates from the inside outwards, flatten the front worktop.

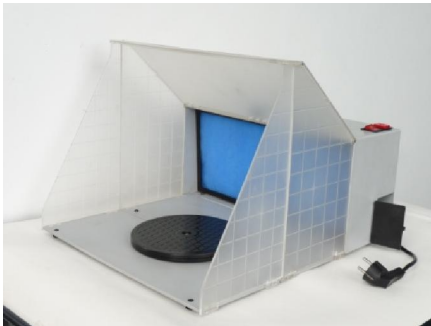

8. Push down the narrow front cover plate (covering of the working surface), fixate it on the right and left side of the chamber. At the same time connect the four notches of the upper plate with the buttons sticking out of the side parts.



9. The right and left sideplates can be placed vertically or taken out. By removing one of them a second chamber can be added and the working surface is doubled.

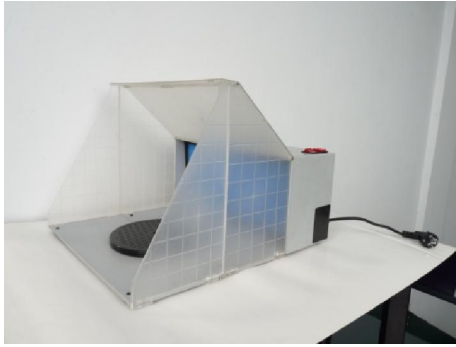

10. After pulling out the cable from the socket, the small flap door can be closed. There is a small hole for the cable; Both devices can operate together.

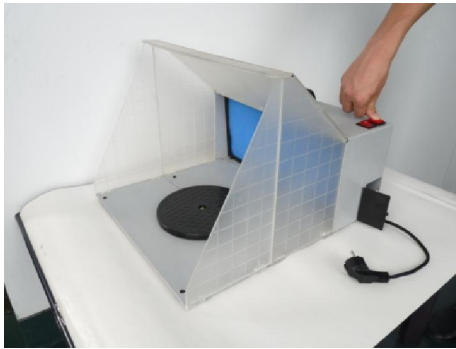

11. Before folding together the unit, press the cable rewind button and the cable is drawn automatically. After this close the flap door. The folding together is carried out the same way as the folding apart but in reverse order.



12. If you would like to use two chambers together, disassemble the left sideplate of the unit on the right and the right sideplate of the unit on the left. After doing this the units can be jointed together.

### Installation Light (optional)

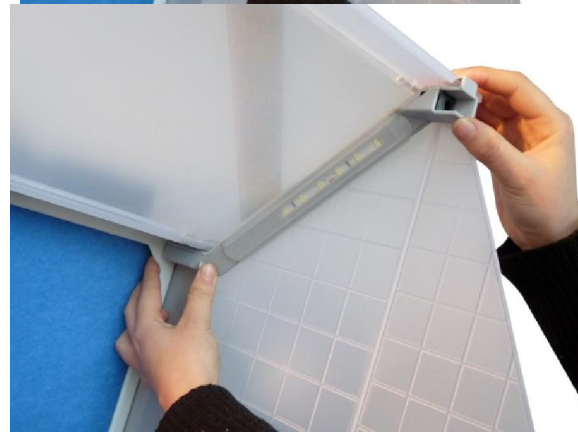



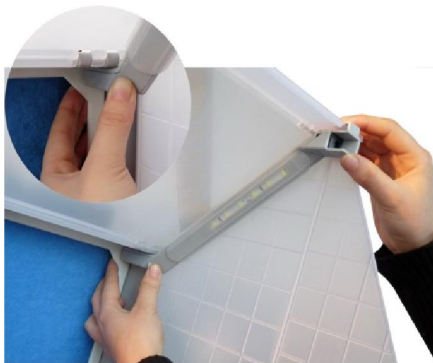
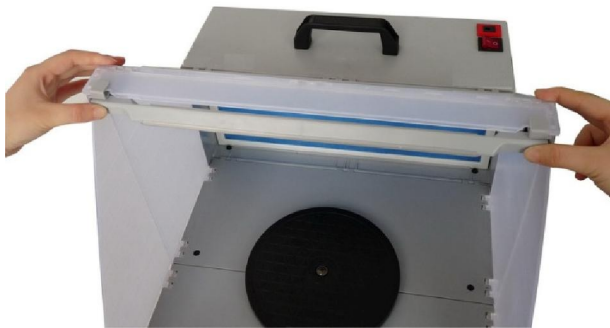
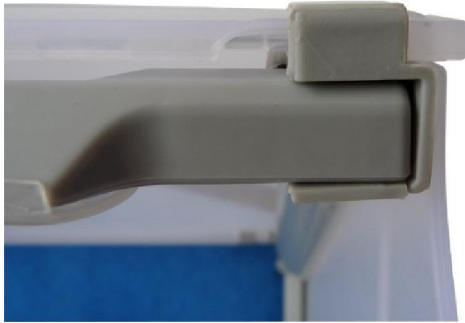

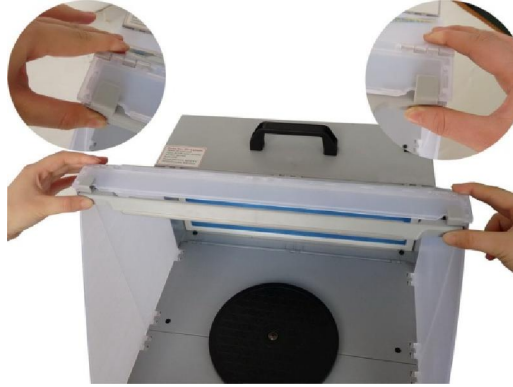

E420H extension tube installation notes (optional - sold separately)

The E420H is compatible with the spray booth E420. This combination leads to optimal result-sen. Not only the paint mist is filtered, but also noxious fumes are passed through the HS-E420H hose. This procedure makes the air in their workspace sau-ber and fresh.

1. Functions:

- a) smart, lightweight, easy to assemble and disassemble.
- b) The length of the hose can be varied from 0.7 to 1.7 meters.
- c) The long flat exhaust can be pressed to 25mm from both sides, so that it fits in the window or door gaps.

2. Parts List:



1. plastic sleeve    2. soft threaded    3. Hose Clamp    4. Extension tube    23. Exhaust port

3. Safety:

CAUTION:

1. When using the extension tube, take out a layer filter net from the spray booth. In the spray booth are two layers filter network is used only one of which, if you use the extension hose.
2. Unscrew the 4 screws from the protective grille on the back of the HS-E420 spray booth. Explore therefore you picture 1 on.
3. Use the 4 screws (you unscrewed in the previous step) to the plastic sleeve to connect (parts lists piece 19) with the HS-E420 spray booth. You should research note the photo 2 on.
4. Screw the threaded sleeve soft (parts lists piece 20) and the extension hose (parts lists piece 22) together and connect them to the extension tube to the exhaust opening (partial lists piece 23). Please take a look to the photo 3 to
5. Insert the hose clamp (part lists piece 21) to the soft collet (part lists piece 20) and screw it into the plastic sleeve (part lists piece 19). Explore to note the photo 4 to.
6. Extend. Hose to suit your needs and place it out of a window or door Explore to note the photo 5 to.



The alternative fitting is done by attaching the plastic sleeve to the ventilation grid. The removal of the screws and the grid as described in 2-5 is not applicable.

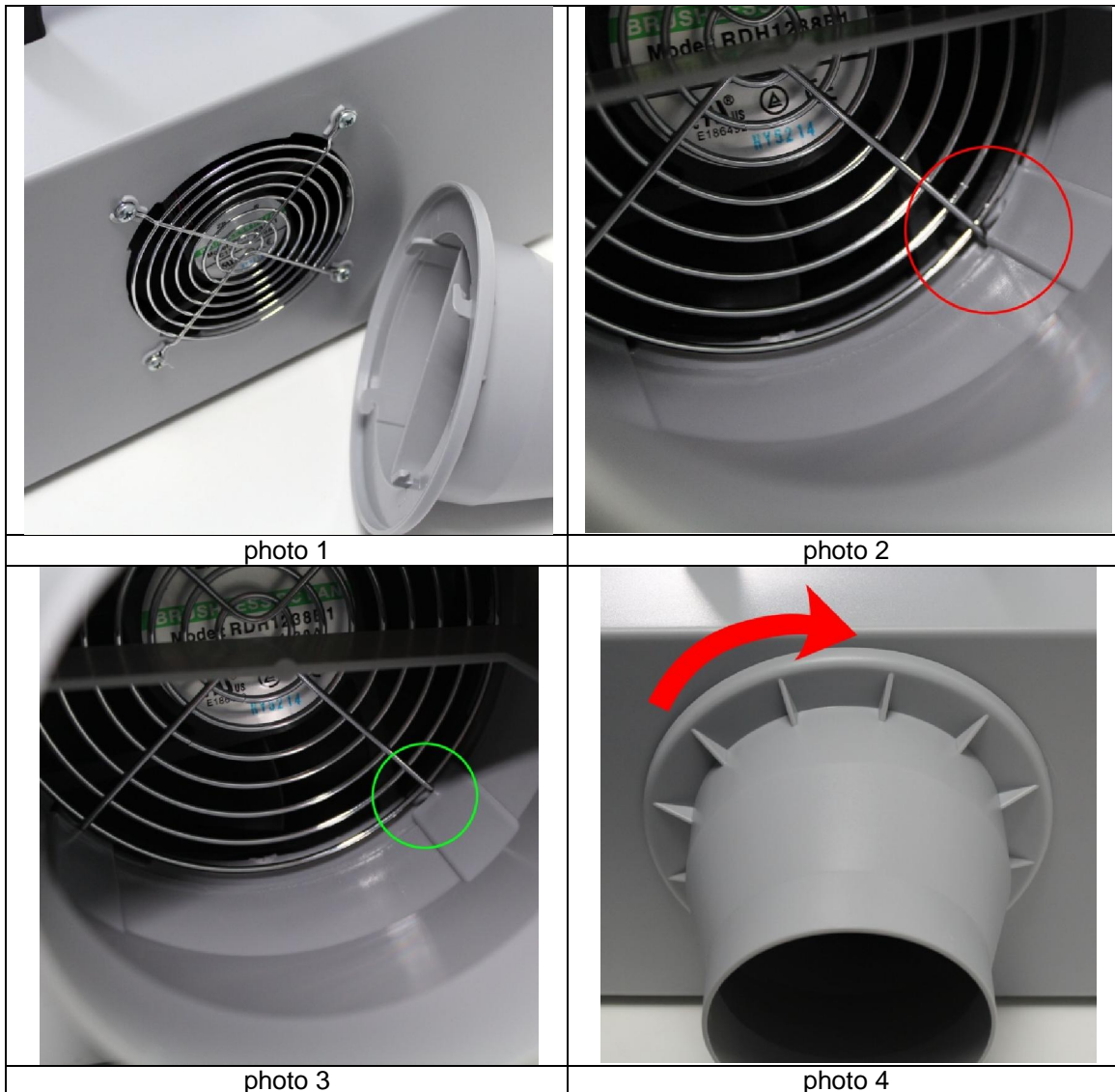

Please pay attention to attach the plastic sleeve solidly to the ventilation grid. (You can see the correct installation on photo 3)



## Warnings and safety instructions

Please read the operation manual thoroughly before using the unit for the first time; it contains important information about the unit's correct operation.

- The warranty/guarantee is no longer valid if the device suffered a damage that resulted from non-compliance with the safety regulations and the operating instructions. No liability or responsibility is assumed for subsequent damage!
- Furthermore, we exclude any liability for personal injury or damage to property caused by improper use or disregard for safety regulations! In such cases the warranty/guarantee is cancelled.
- The unauthorised modification, change or disassembling of the device is for safety reasons not allowed.
- The device is not a toy and must be stored out of reach of children. Great caution is required when children are present.
- The device is designed for use in dry interiors (no bathrooms or similar damp rooms). Otherwise there is danger of deadly electric shock.
- Do not expose the unit or its related equipment to damp, extremely high or low temperatures.
- Do not leave its packaging unattended because children can play with it and injure themselves.
- Throwing or dropping the device as well as pressure or tractive forces can lead to the impairment and disruption of the unit's functions.
- Do not ever place the unit in the proximity of easily inflammable material, like drapes or curtains.
- Always make sure that the rotating disk, on which the object you work on is placed, is positioned in the middle of the housing chamber!
- The unit should remain switched on after each use for 2 - 6 minutes, because the self-cleaning of the device is carried out.
- Switch off the device and disconnect the plug from the socket, if the spray booth is not in use!
- If the filter is filthy with a considerable amount of colour/paint, it can no longer work efficiently and has to be replaced with a clean filter.
- To avoid damage to health do not ever use toxic paints, flammable or explosive colour/paints and materials!
- Make sure you have adequate ventilation!
- In industrial facilities one must comply with the accident prevention regulations of the employers' liability insurance association for electrical installation and equipment.
- In schools, education and training facilities as well as in do-it-yourself repair shops and hobby workshops the use of the equipment must be monitored by trained personnel in a responsible manner.
- If you have any reason to believe that a safe operation is not possible anymore disconnect the device from the electric system and secure it against unintentional operation.

**It can be assumed that a danger-free operation is not possible anymore if:**

- the device exhibits visible indication of damage,
- the device does not function anymore,
- the device was stored for a long time under bad conditions
- the device was exposed to heavy wear and tough conditions while transported.